

ALM.090.400

WALL MOUNTED MODULE HORIZONTAL 325°

ALM.090.400 Wall Mounted Module Horizontal 325° is designed for situations where connection to the floor is impossible and the connection point is desired to be high in a wall/machine-like structure. It allows the operator's arm to move on the horizontal axis. Right - left

With 320° of movement, this module is specially designed for heavily loaded configurations.



ALM.090.400

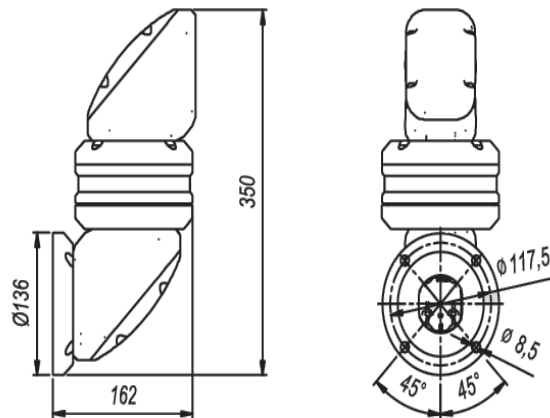

DRAWING

ALUMINUMARM SUPPORT ARM AND ENCLOSURE

www.aluminumarm.com

info@aluminumarm.com