

## ALM.060.640

### Ø105 PANEL COUPLING NON ROTATABLE

The panel vertical entry apparatus provides the connection between the operator panels and the operator arms.

The product's max. diameter is Ø105mm.

Our apparatus allows fixed type of connection.

This apparatus is specially designed for panels with a minimum depth of 110mm.

This product is compatible with the ALM.1120 Series...



**ALM.060.640**

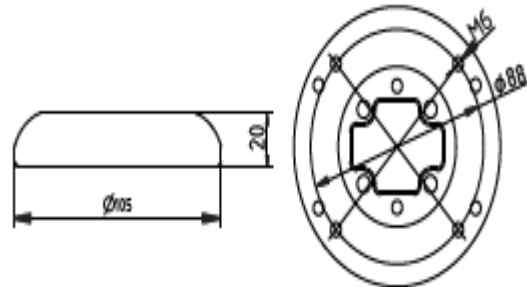

**DRAWING**

**ALUMINUMARM SUPPORT ARM AND ENCLOSURE**

[www.aluminumarm.com](http://www.aluminumarm.com)

[info@aluminumarm.com](mailto:info@aluminumarm.com)